



Nebraska Public Power District  
Always there when you need us



March 2015

Muddy Creek 115 kV

# Transmission Line PROJECT

## Attend an open house and learn more about the Muddy Creek to Ord Transmission Line Project

Three alternative routes and substation sites will be presented for public input during two upcoming open houses March 24 and 25, as part of Nebraska Public Power District’s Muddy Creek to Ord 115,000-volt transmission line project.

This will be the third round of open houses on the project by NPPD since September 2014. Since then the project team has been reviewing public comments and meeting with various agencies while working to narrow the previously announced corridors down to three alternative routes. Senior Project Manager **Mike Hasenkamp** noted, “Although we have identified three alternative routes for this project, no final route has been determined. This open house will be another opportunity to gather additional comments from landowners before making a final line route determination.”

The Tuesday, March 24 open house will be held at the Broken Bow City Auditorium, 314 S. 10th Avenue, in Broken Bow, and the Wednesday, March 25 session will be held in the Exhibit Hall at the Valley County Fairgrounds, 801 S Street in Ord. Hours for both open houses will be from 2 to 8 p.m., and attendees should allow 45 minutes to walk through the displays, provide input, and interact with NPPD representatives.

The Muddy Creek to Ord 115,000-volt electric transmission line project will run from a new substation, to be called Muddy Creek located near an existing transmission line northeast of Broken Bow, to an existing substation near Ord. The location of the new Muddy Creek substation is yet to be determined. The route of the line is estimated to be 42 miles in length, and no route has been determined. This transmission line project will address voltage and loading issues in the immediate area and meet the North American Electric Reliability Corporation’s Reliability Standards for the central Nebraska area.

### Open House Schedule 2 p.m. - 8 p.m.

March 24, 2015  
City Auditorium  
314 S. 10th Avenue  
Broken Bow, NE

March 25, 2015  
Valley County Fairgrounds  
Exhibit Hall  
801 S Street  
Ord, NE

Please allow 45 minutes to walk through the open house and talk to NPPD representatives.

“We continue to have good turnout for the open houses by landowners and other interested parties,” said Hasenkamp. “Any landowners who were unable to attend the first two open houses and want to comment on their specific property are encouraged to come to this open house.”

*(continued on back page)*

All landowners are encouraged to follow developments of the project at <http://www.nppd.com/muddy-creek-ord/>

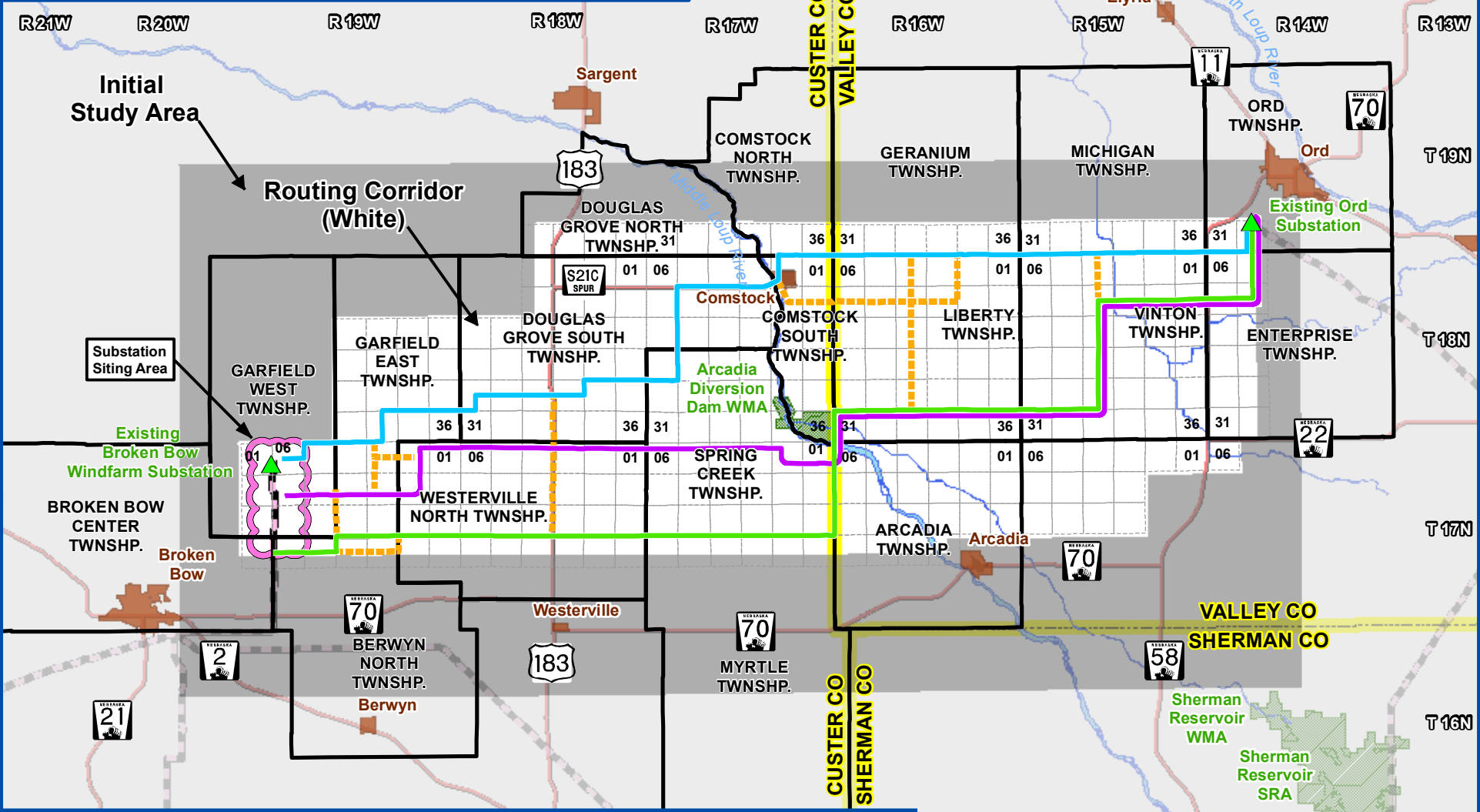

**Legend**

Existing 115kV Substation	Muddy Creek Substation Siting Area	Alternative Route - Green
Highway	Wildlife / Recreation Areas - NGPC	Alternative Route - Blue
Existing 115kV Transmission Line	Waterway	Alternative Route - Purple
Township	County Boundary	Alternative Route - Connector
Municipal Limits	Routing Corridor (White)	Section

NOT TO SCALE

**Muddy Creek to Ord  
115 kV Electric Transmission Line  
Alternative Route Map**

Nebraska Public Power District  
*Always there when you need us*

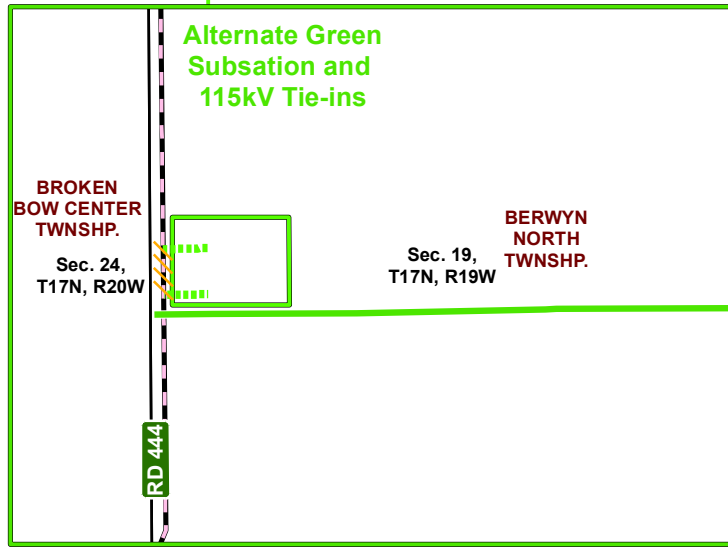
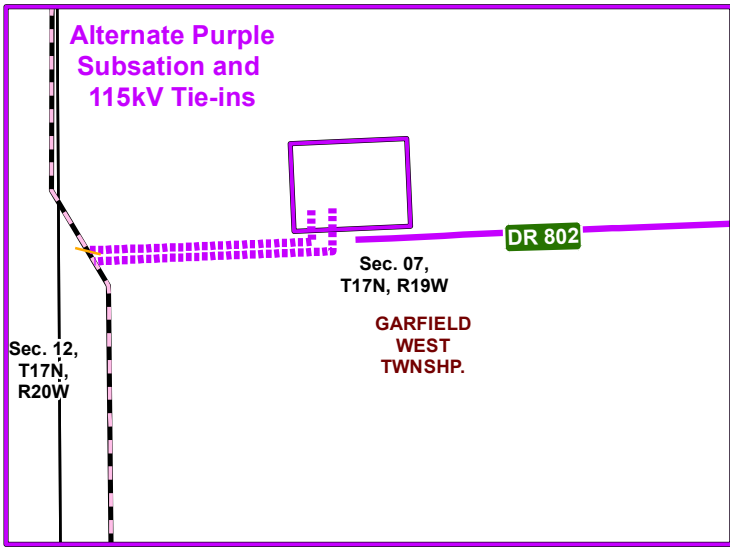
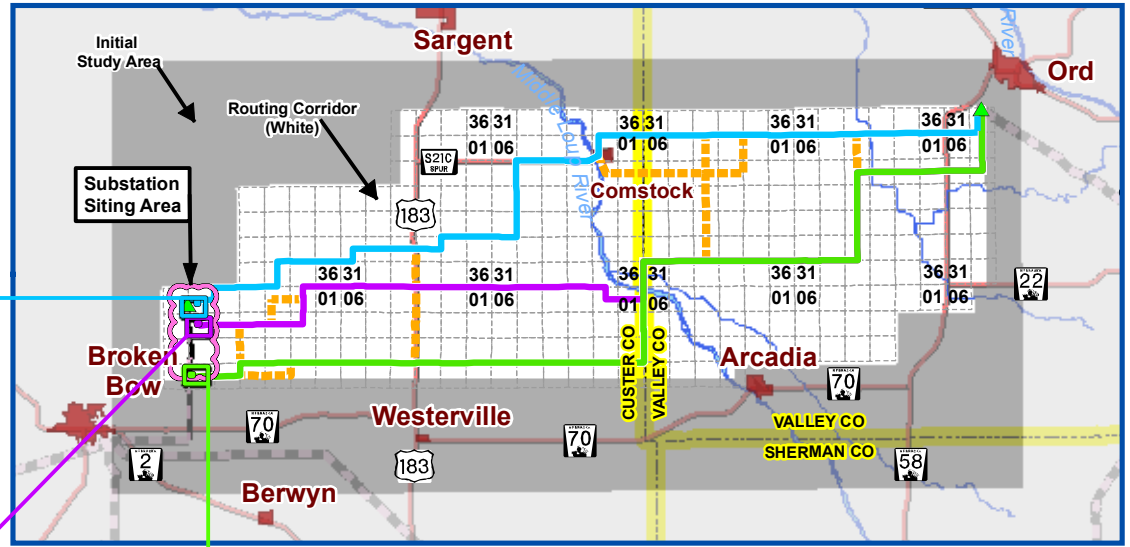
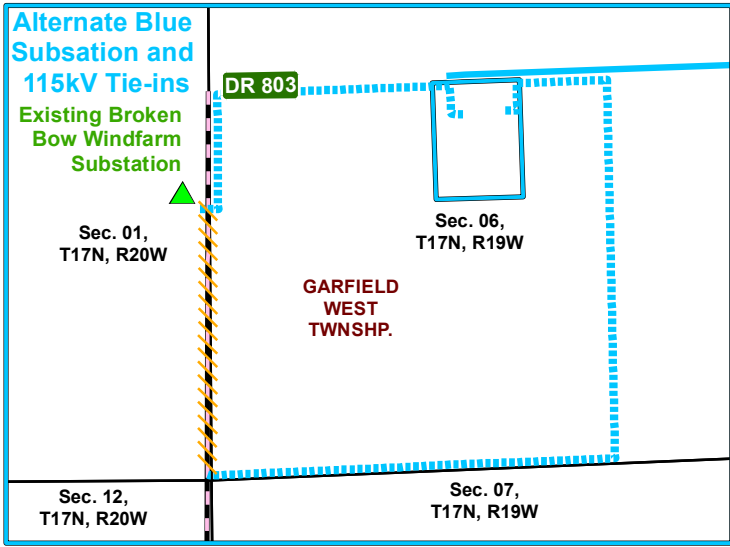

**Muddy Creek to Ord  
115 kV Electric Transmission Line  
Alternative Substation Map**



Nebraska Public Power District  
Always there when you need us



**Legend**

Existing 115kV Substation	Muddy Creek Substation Siting Area	Approximate 115kV Line Removal	Alternative Route Blue - 115kV Tie-ins	Alternate Green Substation Location
Highway	Waterway	Alternative Route - Green	Alternative Route - Purple	Alternate Blue Substation Location
Existing 115kV Transmission Line	County Boundary	Alternative Route Green - 115kV Tie-ins	Alternative Route Purple - 115kV Tie-ins	Alternate Purple Substation Location
Municipal Limits	Routing Corridor (White)	Alternative Route - Blue	Alternative Route - Connector	Section

# Transmission Line Project open houses set for March 24-25

(continued from front page)

The new line will play a vital role in enhancing the reliability of the transmission system in central Nebraska where electric load continually grows. In July 2012, a prolonged period of high temperatures combined with drought-like conditions, resulted in NPPD setting a record for peak electrical load needed by customers of 3,030 megawatts. The result was that NPPD's transmission system in the central part of the state was stretched to the limit during the record load period.

Over the past two years, NPPD has temporarily located additional mobile generators in the central part of the state during the summer months in order to help maintain reliability of the transmission system. NPPD plans to have mobile generators in place again this summer.

The need for the line was identified through the Southwest Power Pool's transmission planning process, which is performed annually to assess system upgrades. The approximately \$34 million transmission line project is expected to be in service in the summer of 2018. Along with the transmission line work, the project also includes upgrades to the existing Ord substation and construction of a new substation east of Broken Bow.

For more information on this project, visit the website at [www.nppd.com/muddycreek-ord](http://www.nppd.com/muddycreek-ord), send an email to [powerline@nppd.com](mailto:powerline@nppd.com), or call the project hotline at 1-888-677-3412.



**The Muddy Creek-Ord 115 kV Transmission Line Newsletter** is published by NPPD's transmission project team. It is intended to provide a project overview and communicate project developments.

Contributors: Project Manager **Mike Hasenkamp**.  
Project Team: **Al Beiermann, Brenda Blatchford, Ross DeBower, Larry Linder, Tom Pillen, Kevin Stachura, Ron Starzec and Dave Wolff.**

Printing and artwork:  
**Bill Haack, Dan Zastera and Scott Margheim.**

Editor: **Jill Novicki**

**Contact us**  
**Email:** [powerline@nppd.com](mailto:powerline@nppd.com)  
**Phone (toll-free):** 888-677-3412

**Mailing address:**  
*Muddy Creek-Ord 115 kV Transmission Line Project,*  
NPPD, P.O. Box 499  
Columbus, NE 68602-0499  
Attention Jill Novicki

**Website:** [www.nppd.com/muddycreek-ord](http://www.nppd.com/muddycreek-ord)

3E1DFBEF



**Nebraska Public Power District**  
*Always there when you need us*

P.O. Box 499  
Columbus, NE 68602-0499

Address Service Requested

